

Father Andrew White, SJ School Crusaders Q & A August 9, 2020



Father Andrew White, S.J. School

TOWN HALL GOALS

- Provide additional information enabling parents to make informed decisions
 - What can FAW provide?
 - What is **Safe**
 - What is **Feasible**
 - What is **Practical**
 - What is **Equitable for all students**

PLAN DEVELOPMENT/ APPROVAL PROCESS

- Reopening Working Group –faculty, staff, School Advisory Board, parents, school administration
- Subcommittees worked in pairs on 5 main areas of the plan – Facilities & Operations, Health & Safety, Catholic Identity, Academics, Marketing & Communication
- Reopening Survey used to collect parent input
- ADW required assurances related to facility, health/safety, academics, Catholic identity and communication
- Submission of the plan by Fr. Beaubien and Ms. Francisco; approved by the ADW

GUIDING PRINCIPLES

- A commitment to the health, safety and well-being of FAW students, families, faculty and staff
- Planning, implementation, revision of plans based on guidance/mandates of CDC, ADW, Maryland Office of Child Care, Maryland and St. Mary's County Health Departments and Governor Hogan

IN-PERSON or DISTANCE LEARNING

- PARENT CHOICE
- Instruction provided by classroom teachers
- Students in distance learning attend daily class with their in-person classmates, receiving the same, real-time synchronous instruction as their peers in the classroom. Opportunities afforded distance learners will mirror in-person learning to the extent practical
- Parents asked to complete the Safe Return and Reopening Survey indicating choice for in-person or distance learning by 8pm on Monday, August 10th

DAILY HEALTH SCREENING

- At-home screening prior to leaving for school; any student with a temperature over 100.4* should remain at home; inform the school of illness and symptoms
- Parents will be asked to sign COVID-19 Acknowledgment Form
- Temperature checks before students exit the vehicle or bus; students asked a series of health screening questions prior to exiting the bus or vehicle
- Parents should keep child home if symptomatic for anything or if there is suspected exposure to COVID-19, even without symptoms

PHYSICAL DISTANCE and MASKS

- In the classrooms- student desks will be 6 feet apart
- All students are required to wear masks during arrival and dismissal and when walking through the hallways/common areas
- Parents/Guardians are asked to provide masks for their children.
- Solid color mask without graphics preferred
- Masks removed/lowered for snack/lunch time and when drinking water
- In the event that a student's mask is deemed ineffective school will provide student with a sterile disposable mask

TO BE CLEAR ABOUT MASKS

- All students are required to wear face coverings while inside FAW
 - EXCEPTIONS: PER ADW
 - Children in Kindergarten and Pre-K when in the classroom
 - Anyone with a doctor's note and prior approval by principal and school nurse
 - Anyone who is unconscious, incapacitated, or otherwise unable to remove the cloth face covering without assistance
- Supervised “mask breaks” (snack/lunch/recess times) will be provided at a time when physical distance can be maintained

NECK GAITERS AND BANDANAS

- Neck gaiters are acceptable as long as they fit properly, covering the nose and mouth
- Face shields also permitted during the school day but must be worn with a face mask or gaiter
- Solid color gaiter masks are preferred
- Bandanas are not allowed as a face mask or covering

SAFETY PRECAUTION TRAINING

- During in-service days, teachers will receive training on safety precautions provided by the ADW to include:
 - Handwashing
 - Mask and face shield care
- During the first days and week of school and on an ongoing basis, students will receive training on safety precautions provided by the ADW including:
 - Handwashing
 - Safe mask handling
 - Restroom procedures
 - Physical distancing

SAFETY PROTOCOLS for TEACHERS

- Faculty and staff will wear face coverings throughout the school day in all areas of the building
- Teachers will wash hands/use hand sanitizer throughout the day as they move from one classroom to another
- Teachers will maintain physical distance/limit close contact with students to the extent practical

STAFFING QUESTIONS

- The ADW has provided and will continue to provide professional development to teachers related to teaching online
- Teachers will teach the curriculum for modified instructional minutes
- Positions to fill - PK aide and substitutes
 - Not unusual for this time of year but is critical for the plan to be effective
 - Any parent interested in becoming a substitute is welcome to apply

CATHOLIC IDENTITY AND FAITH LIFE

- With current physical distancing limitations, it is not possible for the entire school to attend Mass at one time
 - Classes will be scheduled to attend a different weekday (Tuesday-Friday) Mass
- Sacrament preparation for 2nd and 8th grade students in both learning formats

IN-PERSON LEARNING BASICS

- Masks and daily health screening are required for all students who attend class in-person
- Staggered morning drop-off times and assigned entry points
- Car rider arrival and dismissal details are being finalized and will be shared soon
- We anticipate some challenges and ask for your patience as we begin this school year

IN-PERSON INSTRUCTION

- Students in most grade levels divided into two groups to accommodate the 6ft distancing requirement
- All students taught equally by their teacher
 - Teachers move between classrooms
 - One group supervised by instructional assistant
 - Less instructional minutes for each content area to allow for frequent breaks
 - Teachers/Administration creating the weekly schedules

EXTRA CLASSROOM SPACE

- Library, Science Lab, Art/Music room and Gym
- Teachers will be permitted to use outdoor space for instruction provided teachers and students adhere to physical distancing requirement

THE CLASSROOMS

- No more than 15 students are in each classroom and students will remain in the same space all day for instruction and lunch
- Separate classrooms for divided grade levels but close enough so teachers can transition from one space to the other
- Student desks are 6 feet apart
- Masks are required in classrooms for both student and teacher

Father Andrew White School

POSSIBLE ROOM ASSIGNMENTS

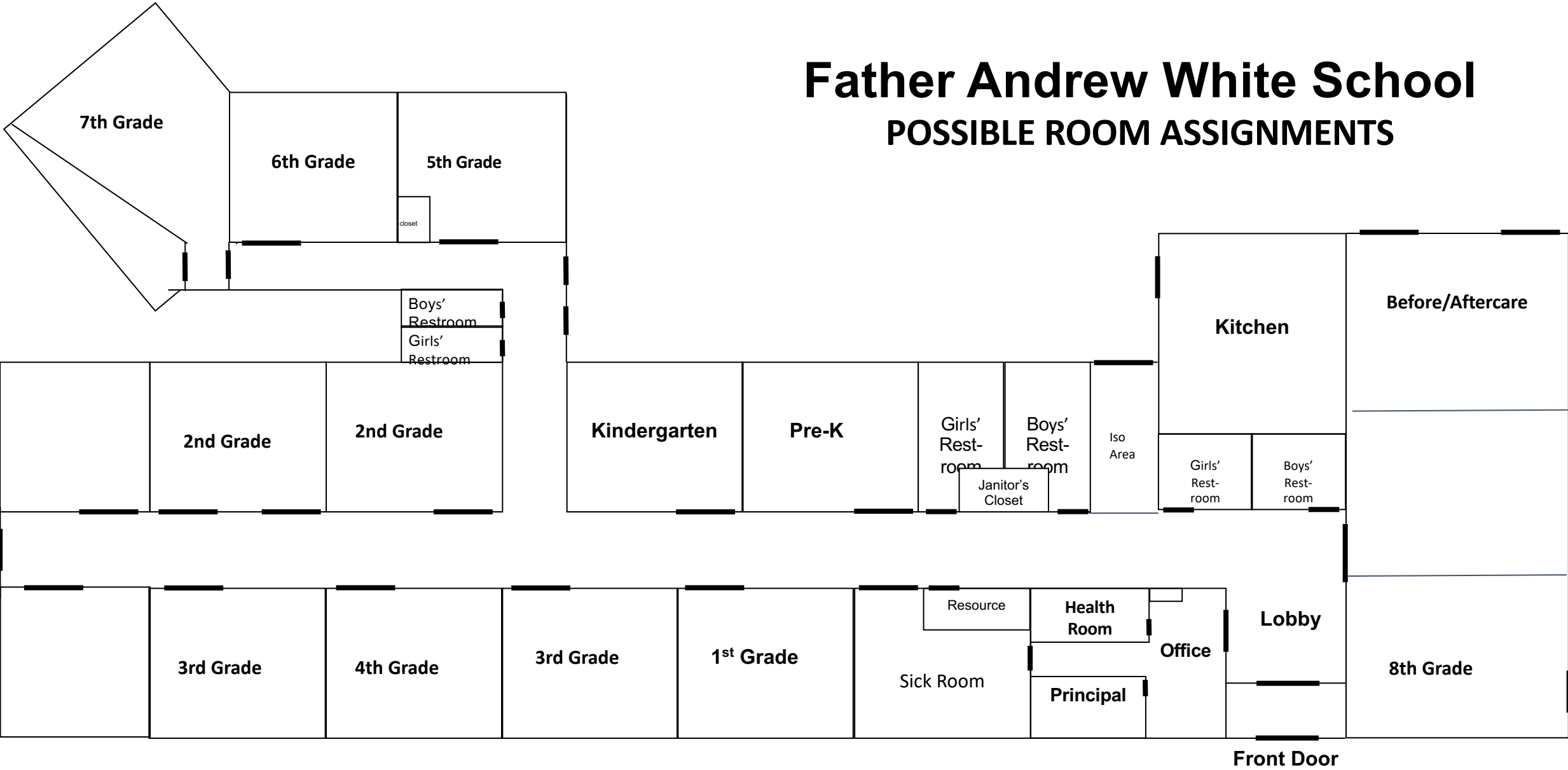

LEARNING RESOURCE

- Mrs. Black will contact families to provide details on plans to meet individual learning needs and review/revise students' Catholic Accommodation Plans (CAP)
- When needed, Mrs. Black will work with students in the resource room

BACKPACKS, COATS, CELL PHONES and LUNCHES

- Backpacks and coats will be kept on hooks or in cubbies with additional space between them; coats will be stored inside backpacks
- Cell phones will not be collected. Cell phones must remain inside students' backpacks and must be turned off
- Students can bring lunch from home or place an order through Orgs Online for a grab-and-go style lunch that will be delivered to the classroom
- Milk will be available for purchase; order forms will be available

FAW ALLERGY ACTION PLAN

- Due to limitations imposed by the pandemic, all students will eat in their classroom
- Many FAW students have allergies
- Parents will be notified if there is a student with a peanut allergy in the classroom
 - This means NO PEANUT products for that classroom.
 - Students will clean their own desks and chairs after lunch with approved cleaning products

RECESS

- Students will have recess and remain in their class group
- Groups of students will not mix during recess and 30 ft. of space will be maintained between groups
- Each group will have its own equipment that will be cleaned after each use with approved cleaning products
- Students will be taught/encouraged to play games with limited contact
- Teachers will have flexibility to schedule additional breaks/recess as appropriate

SPECIALS CLASSES

- PK-5th grade students will participate in specials classes, including PE, Art, Music, Technology and Spanish
- Teachers will go to the classrooms, except for PE where students will use outdoor areas (weather permitting) with physical distance for stretches and exercise
 - Students will wear masks to and from PE
 - No singing is permitted in music class; teacher and students will focus on music theory and history of music

SOCIAL- EMOTIONAL LEARNING

- The curriculum will include dedicated lessons focused on FAW students' social-emotional learning (SEL) needs
- Now more than ever, it's critical for students to be equipped with the necessary skills to express and regulate their emotions, problem solve, develop and strengthen relationships, reduce stress and anxiety, and build resiliency
- The ADW will provide strategies and assistance to schools to help with the needs of our staff and students

SCHOOL SANITIZATION

- Janitorial staff from B & B Maintenance will be on-site after school hours
 - Building is used only during the day with no afternoon or evening activities except aftercare
 - Daytime use of building is limited to FAW with all other uses suspended, to decrease the cleaning load
 - Cleaning will occur throughout the day and proper cleaning of high-traffic areas and high-touch surfaces will be a top priority

FILTERING AIR THROUGHOUT BUILDING

- As required by law for all educational buildings, outside air must make up a large part of the heating and cooling system for all schools.
- We use in all our HVAC (Heating and ventilation and Air conditioning System) systems the higher end pleated filters (2 “ thick)
- Filters are commercial grade and thickness. Filters changed and equipment inspected regularly.
- HVAC systems are a priority
- Per CDC guidelines, circulating outside air reduces virus spread, classrooms will also open windows to circulate air as the outside weather permits.
- Desk or floor fans will not be used in the classrooms.

HANDWASHING/ HAND SANITIZERS

- Opportunities for increased handwashing with soap and water throughout the day
- Students may not keep hand sanitizer or wipes at their desk. They can have a small, individual sized bottle that clips to their lunchbox that is not shared with others

RESTROOMS

- Students will be able to use the restrooms as needed and classes will have scheduled blocks of time for restroom breaks to minimize the number of students in the hallways at any one time
- Classes will use the restroom that is closest to their assigned classroom space
- Students must wear masks when using the restroom
- Students must wash their hands before entering and exiting the restroom

DISTANCE LEARNING

- Families/Students who opt for distance learning will **follow the class schedule and classes will be live-streamed through Zoom or Google Meet**
- Students will be able to ask questions and participate in discussion
- The classroom teacher will be available for distance learners to support instruction and study skills needs of students, as time permits.

DISTANCE LEARNING LOGISTICS

- Each student within a family will need access to a separate (not shared) device during the school day. Students also need access to internet and a printer. Parents can request use of school owned devices (iPad or Chromebook).
- Distance learning students will need to be able to print although most assignments will be managed digitally
- Prior to the start of the school year, students will be assigned a time to pick up textbooks/workbooks and materials

DISTANCE LEARNING EXPECTATIONS

- Expectations for students on distance learning include, but not limited to:
 - Dress in school appropriate attire – No pajamas!
 - Participate in class in real time and be an active part of the community
 - Students must participate in class with their video camera on, student's face must be visible, and use correct first and last name
 - Students should be mindful of their environment
 - Class work needs to be completed, and all assignments turned in, on time and as directed by the teacher.
 - No eating during class
 - Virtual learners will have the same breaks during the day as their classmates who are in the classroom

MOVING BETWEEN LEARNING PLATFORMS

- Parents may change learning option for their children at the end of each quarter only by contacting Ms. Francisco
 - Exception: in-person students who are home temporarily, due to illness, may attend via Zoom or Google Meet once they are feeling well enough
- Families who choose to move from in-person to distance may do so at anytime; however families who commit to distance learning may not return to school in-person until the end of the first quarter.

IDENTIFYING ILLNESS IN STUDENTS

- Once a student/staff presents with COVID-19 symptoms or just does not feel well, the nurse will be notified by classroom phone or two-way radio that the student/staff is being sent down to the nurse for evaluation (this allows the nurse to prepare the sick room & put on appropriate PPE).
- Based on the assessment, if there is a suspected case of COVID-19, a family member will be contacted to pick up the individual and it is expected that the family member arrives within 30 minutes of contact
- If a student has COVID-19 symptoms at home, any siblings of that student should also remain at home until the student has been cleared by a medical professional to return to school
- If a student has COVID-19 symptoms at school, any siblings of that student will be sent home as well until the student has been cleared by a medical professional to return to school

A POSITIVE COVID-19 TEST

- The student/staff member who tested positive, will be asked to stay home to quarantine for as long the person who tested positive is sick and for 14 days after the sick person is out of isolation/or is well
- The student/staff member during the quarantine will be required to provide a letter from a medical professional before they can return to school/work

POSITIVE COVID-19 STUDENT OR TEACHER

- The student or staff is required to notify the school.
- The local Health Department will be notified, based on their investigation, we will be directed on whether to quarantine the whole class or a few students, and thorough communication will be sent to the affected population.
- Cleaning protocols will be followed per CDC guidelines

POSITIVE COVID-19 TESTS AND CLASS QUARANTINE

- When a student/staff tests positive, we are required to contact our local Health Department both to notify them as well as to get directives from the Health Department and the ADW on what the next step will be
- We will not automatically quarantine the entire class, it will be based on the HD assessment and investigation
- Every case and scenario is different so we will quarantine if they advise us to do so

QUARANTINE and COVID- 19 POSITIVE CLASSMATE

- Quarantine will be based on the advice of the local Health Department per their assessment of the situation
- Quarantine of sibling/classmates will be based on the advice of the local HD per their assessment of the situation
- All quarantine decisions based on advice of Health Department

COVID-19 REPORTING REQUIREMENTS

- Parents **ARE** required to report to FAW under these circumstances
 - a) sick with COVID-19 related symptoms,
 - b) tested positive, are being tested for COVID-19 or
 - c) have a COVID-positive person in their household or
 - d) some other known exposure and **have been instructed to quarantine.**

RETURN TO WORK OR SCHOOL AFTER ILLNESS

- COVID-19 illness
 - FAW, under guidance from the archdiocesan plan at this time, requires that the student/staff return to school/work with a note of clearance from their Health Care Provider
- Non-COVID-19 illness
 - The student/staff may return to school after 3 days of being fever, nausea, diarrhea free, without the use of medication

SELF-REPORTING REQUIREMENTS

- All staff/student are required to complete a daily health self -screening tool before coming to school.
- All will sign an agreement prior to return to school that they will be compliant in completing this daily screening and will not come to school if they answer a “Yes” to any question.

SHARING RISK INFORMATION

- After consultation with the local health department, the archdiocesan nurse and the school administrators, teachers, staff & parents will be notified of a confirmed “positive” case of COVID-19 with guidelines on what actions have and will be taken.
- The privacy of the individual will be maintained at all times
- We will not notify anyone of a presumed case since notification will be based only on an assumption.
- It is best practice especially during this pandemic to treat everyone as contagious since not every sick person will show symptoms

AVOIDING OVER- REACTION

- Daily health screening questionnaire helps identify potential COVID cases
- Screening tool must be completed everyday
- Remember, your child has the option of online school while home sick if they are up to it. There is no need to expose others to an illness that is life threatening and that could have been prevented. We need to think about and take care of others

IN THE EVENT OF SCHOOL CLOSURE

- Teachers continue to teach, following an established schedule
- All students will follow a provided schedule
- Specials classes will still occur
- Preparedness measures will be in place for sudden closure to maintain continuity of learning and to ensure students have necessary materials at home if a return to the building is not possible

FAMILY TRAVEL DURING SCHOOL YEAR

- Please follow CDC/local Health Department guidelines regarding whether to quarantine after returning from a trip
- We strongly recommend that families consider quarantining for 14 days if they choose to travel outside the state of Maryland
- Parents/guardians that are required to travel for work related business are strongly encouraged to consider quarantining with their families for 14 days after they return from their trip.

VOLUNTEERS and VISITORS

- In an effort to reduce the risk of exposure to our students, faculty and staff, visitors and volunteers will have limited access to the school building
- A parent, volunteer or other visitor who makes an appointment or is given prior permission to enter the building, must do the following:
 - Wear a face covering at all times
 - Sanitize hands upon entry
 - Conduct a temperature check using the hands-free thermometer mounted on the wall outside the office door
 - Check-in through the office
 - Provide responses to health screening questions

STUDENT PRIVACY

- The privacy of students online and in the classroom will be protected
- Teacher/classroom microphones turned on for active instruction, and turned off during classwork/practice
- Online students' view will be of the teacher and his/her instructional space
- In-person students will not be individually visible

SMCPS and FAW

- FAW will follow SMCPS for weather related closures and delays
- FAW will shut down due to COVID-19 at the direction of Gov. Hogan, the MD Dept of Health, the ADW

FIRST WEEK SCHEDULE/ CALENDAR CHANGE

- The first four days of school, Tuesday, August 25-Friday, August 28 are now scheduled to be early dismissal days
- Dismissal will begin at 12:30

GOING FORWARD

- Per ADW guidelines:
 - CREATE A PLAN
 - IMPLEMENT THE PLAN
 - EVALUATE THE PLAN
 - CHANGE THE PLAN

Can things change? Absolutely!

- FAW reserves the right to change and update the reopening plan, the handbook, operations or anything else as circumstances warrant with reasonable notice to the school community

OUR PARTNERSHIP: THE CULTURE of SAFETY

- Please comply with request for daily temperature check and health monitoring
- Please discuss expectations for maintaining physical distance and complying with mask rules with your child
- Please teach your child how to safely raise and lower masks
- Please help your child understand, in an age appropriate way, that everyone plays a role in keeping everyone else safe
- Please teach your child how to wash his/her hands properly
- Please communicate any concerns to administration

REOPENING REALITY

This plan is subject to change at
anytime based on state and
local mandates.